

Converter

MIDORI PA-420



General

- Signal transducer package for CP-2UN and CP-2UTN
- Current Output 4~20mA

Material

- Housing: Epoxy Resin, Copper Alloy, Nickel Plate

Dimension (mm)

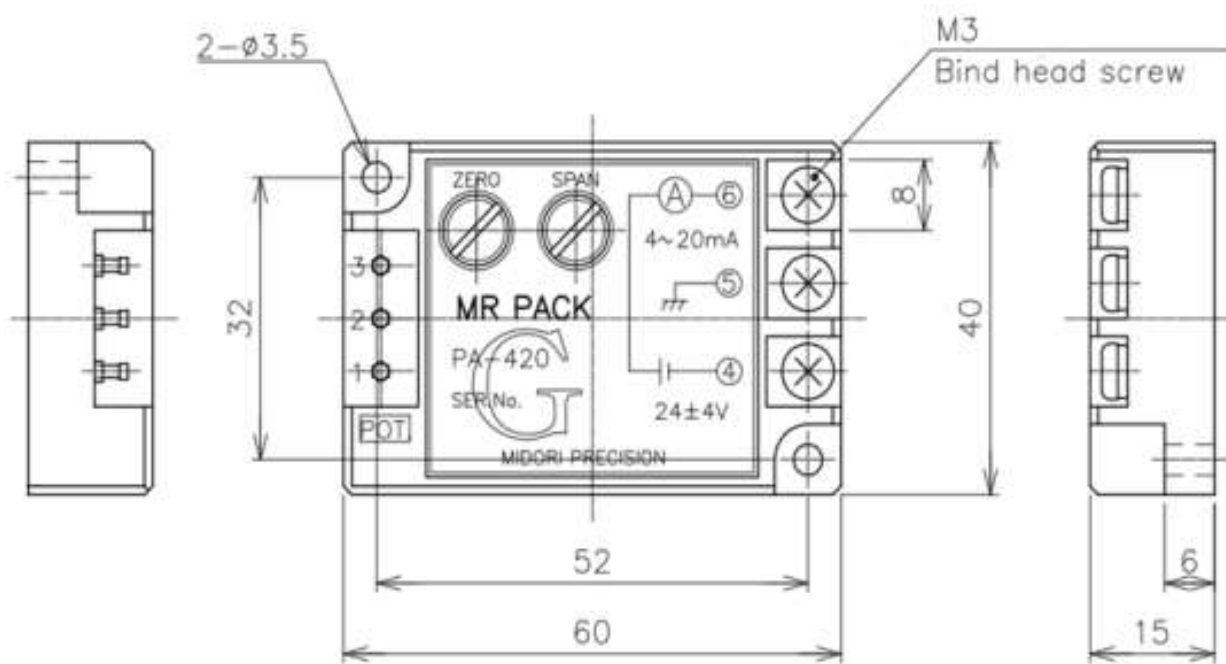

Mounting(mm)

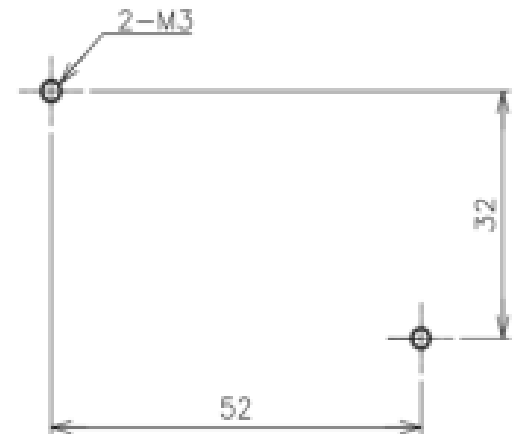

Schematic

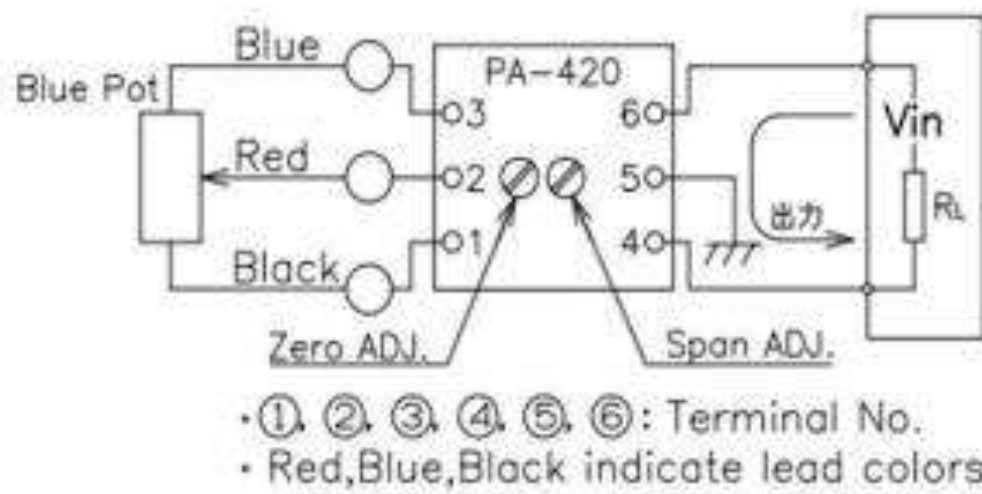

Specifications

Output	4~20mA
Supply Voltage	DC24 \pm 4V
Load Impedance (RL)	600 Ω MAX. (24V)
Operating Temp.	-20~70 $^{\circ}$ C
Adjustable Range	Start Position: 31~47%/Vout of CP-2UN/ CP-2UTN End Position: 12~32%/Vout of CP-2UN/ CP-2UTN

PA-420 Setting

1. Adjust output of sensor to a minimum value of measuring range.
2. Start-point setting: Set output of PA-420 to minimum value to rotate START ADJ trimmer (ZERO Trimmer).
3. Adjust output of sensor to maximum value of measuring range.
4. End-point setting: Set output of PA-420 to maximum value to rotate END ADJ trimmer (SPAN Trimmer).
5. Repeat the process 1 ... 4 until the adjustment is complete.

Handling Instruction

- Do not use with Blue Pot with built-in amplifier.
- Do not use for Hall-effect sensor or sensor with IC.
- Do not supply surge voltage into the transducer.
- Should supply DC1.5V into CP-2UN/ CP-2UTN.
- When adjust zero or span, remove their screws with slit first, then adjust them to turn screws on trimmer.